



1.0 PRODUCT DESCRIPTION

Available Sizes

- $\frac{3}{4}$ – 12"/DN20 – DN300

Maximum Working Pressure

- Fitting pressure ratings are equivalent to the pressure ratings of the coupling used to install them. Coupling pressure ratings are pipe wall thickness dependent.

Function

- Connects pipe sections, provides change in direction, and adapts sizes or components.

All fittings are supplied with Victaulic Original Groove System (OGS) grooves. Fittings are exclusively for use with Victaulic couplings, valves, accessories and pipe which feature ends containing the Victaulic OGS groove profile

Codes and requirements

- Support hanger spacing correspond to ASME B31.1 Power Piping Code and ASME B31.9 Building Services Piping Code

Available Fitting Wall Thicknesses

- Schedule 10S Fittings: See Sections 3.0 and 4.0
- Schedule 40S Fittings: See Sections 3.1 and 4.1

NOTE

- Schedule 40S Fittings are designated with H

2.0 CERTIFICATION/LISTINGS



NOTES

- See Victaulic submittal [publication 10.01](#) for details
- See Victaulic submittal [publication 02.06](#) for potable water approvals if applicable.

ALWAYS REFER TO ANY NOTIFICATIONS AT THE END OF THIS DOCUMENT REGARDING PRODUCT INSTALLATION, MAINTENANCE OR SUPPORT.

3.0 MATERIAL SPECIFICATIONS

Schedule 10S Material Specifications:

Note: Fittings are optionally available in Schedule 5S for 3 – 12"/80 - 300mm.

Elbows:

- Standard: Schedule 10S, Type 304L or 316L stainless steel roll grooved from material conforming to A 403/A 403M, or pipe conforming to ASTM A 312/A 312M, or sheet conforming to ASTM A 240/A 240M.
- Optional: 1 – 2 ½"/DN25 – 65 mm and 76.1 mm 90° and 45° Elbows available in Schedule 10S, Grade CF8M (Type 316 stainless steel) conforming to ASTM A 351/A 351M, A 743/A 743M and A 774/A 744M.

Tees & Reducing Tees:

- Standard: Schedule 10S, Type 304L or 316L stainless steel roll grooved from material conforming to A 403/A 403M, or pipe conforming to ASTM A 312/A 312M, or sheet conforming to ASTM A 240/A 240M.
- Optional: 1 ½ – 2 ½"/DN40 – 65 mm and 76.1mm Tees available in Schedule 10S, Grade CF8M (Type 316 stainless steel) conforming to ASTM A 351/A 351M, A 743/A 743M and A 774/A 744M.

Laterals, True Wyes, Crosses:

- Standard: Schedule 10S, Type 304L or 316L stainless steel roll grooved from material conforming to A 403/A 403M, or pipe conforming to ASTM A 312/A 312M, or sheet conforming to ASTM A 240/A 240M.

Adapter Nipples:

- Standard: Schedule 10S, Type 304L or 316L stainless steel roll grooved from material conforming to A 403/A 403M, or pipe conforming to ASTM A 312/A 312M, or sheet conforming to ASTM A 240/A 240M.

Concentric Reducers:

- Standard: 1 ½ x ¾ – 2 ½" x 2"/DN40 x DN20 – 65 mm x DN50 and 76.1 x 60.3 mm Schedule 10S, Grade CF8M (Type 316 stainless steel) conforming to ASTM A 351/A 351M, A 743/A 743M and A 774/A 744M.
- Standard: 3 x 1 – 12 x 10"/DN80 x DN25 – DN300 x DN250 Schedule 10S, Type 304L or 316L stainless steel roll grooved from material conforming to A 403/A 403M, or pipe conforming to ASTM A 312/A 312M, or sheet conforming to ASTM A 240/A 240M.

Eccentric Reducers:

- Standard: Schedule 10S, Type 304L or 316L stainless steel roll grooved from material conforming to A 403/A 403M, or pipe conforming to ASTM A 312/A 312M, or sheet conforming to ASTM A 240/A 240M.

Caps:

- Standard: For use with Schedule 10S pipe, Schedule 10S, Grade CF8M (Type 316 stainless steel) conforming to ASTM A 351/A 351M, A 743/A 743M and A 774/A 744M.

4.0 DIMENSIONS (CONTINUED)

Cap

No. 460 SS

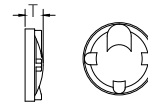

No. 460 SS

Size		No. 460 (Casting) Cap			No. 460 (Flat) Cap		
Nominal inches DN	Actual Outside Diameter inches mm	T inches mm	Maximum Tap Size inches	Approx. Weight Each lbs kg	T inches mm	Maximum Tap Size inches	Approx. Weight Each lbs kg
¾ DN20	1.050 26.9	0.75 19	–	0.1 0.1	0.88 22	–	0.2 0.1
1 DN25	1.315 33.7	0.75 19	–	0.2 0.1	0.88 22	–	0.3 0.1
1 ¼ DN32	1.660 42.4	0.75 19	–	0.3 0.1	1.00 25	½	0.6 0.3
1 ½ DN40	1.900 48.3	0.75 19	–	0.4 0.2	1.00 25	¾	0.7 0.3
2 DN50	2.375 60.3	1.00 25	–	0.6 0.3	1.00 25	1	1.2 0.5
2 ½	2.875 73.0	1.00 25	–	0.9 0.4	1.00 25	1 ½	2.9 1.3
DN65	3.000 76.1	1.00 25	–	1.1 0.5	1.00 25	1 ½	–
3 DN80	3.500 88.9	1.00 25	½	1.1 0.5	1.00 25	2	2.6 1.2
4 DN100	4.500 114.3	1.13 29	½	1.8 0.8	1.00 25	2 ½	4.6 2.1
4 ½	5.000 127.0	–	–	–	1.00 25	–	–
DN125	5.500 139.7	1.38 35	¾	1.8 0.8	1.00 25	3	–
5	5.563 141.3	–	–	–	1.00 25	3	10.1 4.6
	6.500 165.1	1.75 44	¾	4.1 1.8	–	–	–
6 DN150	6.625 168.3	1.75 44	¾	4.0 1.8	1.00 25	3	10.1 4.6
200A	216.3	2.25 57	¾	7.0 3.2	–	–	–
8 DN200	8.625 219.1	2.25 57	¾	7.0 3.2	1.25 32	4	21.8 9.9
250A	267.4	2.75 70	2	7.5 3.4	–	–	–
10 DN250	10.750 273.0	2.75 70	2	17.8 8.1	1.25 32	4	34.0 15.4
300A	318.5	3.25 83	2	–	–	–	–
12 DN300	12.750 323.9	3.25 83	2	26.7 12.1	1.25 32	4	47.9 21.7

NOTE

- End caps are available with an NPT/BSPT tapped port. Contact Victaulic for more information.